

This product list includes all parts necessary for most applications. For parts required for special applications, please refer to the MEVA price list. Dimensions are in centimetres (cm) unless another measure is shown.

Contents

Alignment rails.....	79
Articulated flange nut 15/120	82
AS assembly lock	77
AS crane hook	83
AS hinged inside/outside corner	75
AS inside corner.....	71
AS inside/outside corner 135°.....	74
AS panels	68
AS radius panel.....	76
AS tensioning bow.....	76
AS timber profile.....	79
AS/ST outside corner	72
Brace frame 250	88
Combi-lock with coupling.....	77
Corner bracket 40/60.....	80
Crane slings 40	84
Crane slings Stapos 40	84
Flange nut 100.....	82
Flange screw.....	78
Folding access platform BKB 125	90
Formwork-prop connector	88
Foundation tape	89
Guard-railing post	87
Lifting hook 40	84
M outside corner bracket	80
M profile for extension for guard-railing KLK	86
Multi-purpose panel AL 17	62
Plug D20, red.....	81
Push-pull strut	89
Scaffolding bracket.....	86
Scaffolding tube.....	87
Side railing.....	86
Spanner SW 27	83
Stop end bracket 40/60	81
Stop end fixture 23/40 yellow	81
ST aluminium filler.....	78
ST compensation plate.....	78
ST inside corner	71
ST inside/outside corner 135°	73
ST panels.....	62
ST panel 270/45 with concreting window	71
ST panel AL 17, 270/45 with filling nozzle.....	71
ST stripping corner	75
Swivel-joint coupler 48/48	87
Tensioner AS/ST for foundation tape	89
Tie rod DW 15/90.....	82
Transport angle 12	85
Trolley for foundation tape.....	89
Uni-assembly lock.....	77
Uni-tie claw.....	83

ST panels

Construction height 12 cm; frame profile width 4 cm; two tie holes per panel height 270 cm. Absolute compatibility with AluStar panels. The frames of ST panel frames are made of closed steel profiles and are torsion-proof; corrosion-resistant and easy to clean thanks to a special coating (KTL/ACC). ST panels are standardly fitted with alkus AL 20 all-plastic forming face (panels widths 240 cm, 135 cm) or AL 17. As an alternative, the panels can be delivered with a multi-layer plywood face (18 mm or 15 mm).

All-around grooves and AS assembly locks guarantee a tight and perfectly aligned panel connection. Conical anchor sleeves are welded into the frames. Multi-function profiles permit an easy, fast and safe accessory attachment.

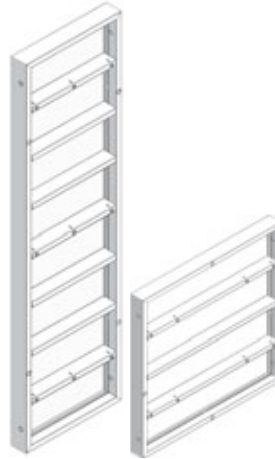

ST panel ... /240 AL20

Suited to stack ST panels 270/240 at the top or bottom



Multi-purpose panel AL 17

StarTec panel with multi-adjustment profiles. To be used as column formwork or to concrete pilasters, stop ends, connections to existing walls, corner configurations, etc.; is used with the stop end fixture 23/40.



Ref. No.	Description / Application	m ²	kg
21-200-03	ST panel AL 20 270/240	6.48	394.0
21-200-06	ST panel AL 20 270/135	3.65	202.7
21-200-11	ST panel AL 17 270/90	2.43	103.2
21-200-26	ST panel AL 17 270/75	2.03	90.9
21-200-46	ST panel AL 17 270/55	1.49	72.8
21-200-49	ST panel AL 17 270/50	1.35	67.9
21-200-52	ST panel AL 17 270/49	1.32	67.1
21-200-56	ST panel AL 17 270/45	1.22	64.0
21-200-61	ST panel AL 17 270/40	1.08	60.2
21-200-71	ST panel AL 17 270/30	0.81	48.4
21-200-76	ST panel AL 17 270/25	0.68	45.7
21-200-78	ST panel AL 17 270/24	0.65	44.9
21-200-81	ST panel AL 17 270/20	0.54	41.4
21-210-06	ST panel AL 17 135/135	1.82	73.3
21-210-11	ST panel AL 17 135/90	1.22	53.6
21-210-26	ST panel AL 17 135/75	1.01	47.3
21-210-46	ST panel AL 17 135/55	0.74	38.6
21-210-49	ST panel AL 17 135/50	0.68	36.0
21-210-52	ST panel AL 17 135/49	0.66	35.8
21-210-56	ST panel AL 17 135/45	0.61	33.9
21-210-61	ST panel AL 17 135/40	0.54	31.0
21-210-71	ST panel AL 17 135/30	0.41	26.7
21-210-76	ST panel AL 17 135/25	0.34	25.0
21-210-78	ST panel AL 17 135/24	0.32	24.4
21-210-81	ST panel AL 17 135/20	0.27	21.1
21-211-11	ST panel AL 17 90/90	0.81	39.3
21-211-26	ST panel AL 17 90/75	0.68	34.6
21-211-46	ST panel AL 17 90/55	0.50	28.3
21-211-49	ST panel AL 17 90/50	0.45	26.0
21-211-76	ST panel AL 17 90/25	0.23	18.1
21-215-00	ST panel AL20 135/240	3.24	217.5
21-215-60	ST panel AL20 75/240	1.80	129.1
21-212-26	ST multi-purpose panel AL 17, 270/75	2.03	103.5
21-212-46	ST multi-purpose panel AL 17, 135/75	1.01	52.2

Panel height = 270 cm StarTec

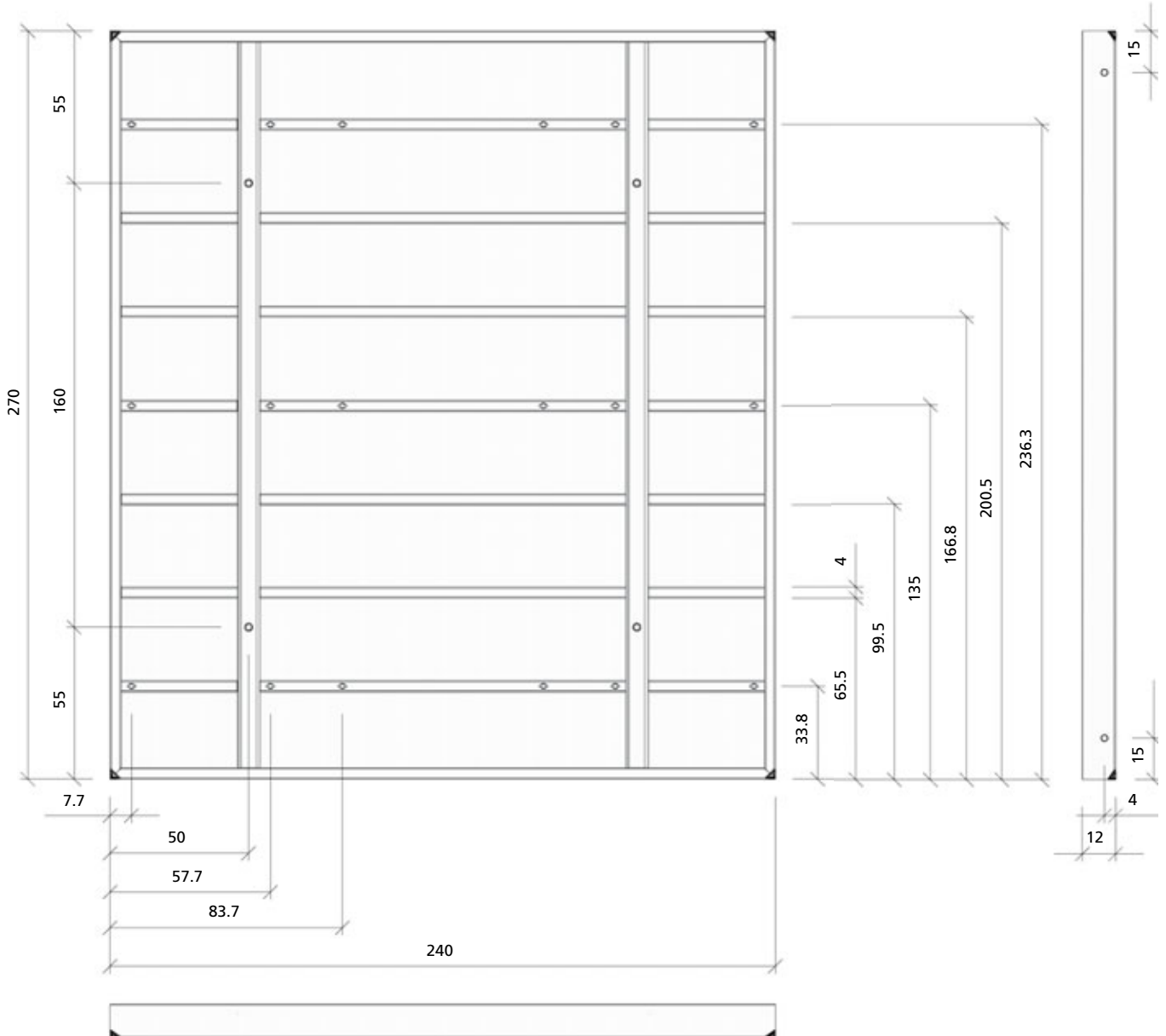

Panel height = 270 cm StarTec

7 cross stiffeners of which 3 are multi-function profiles (welded-in nuts with DW thread)

2 tie holes per panel height

Attention

Tie holes that are not used must always be closed with plastic plug D20.

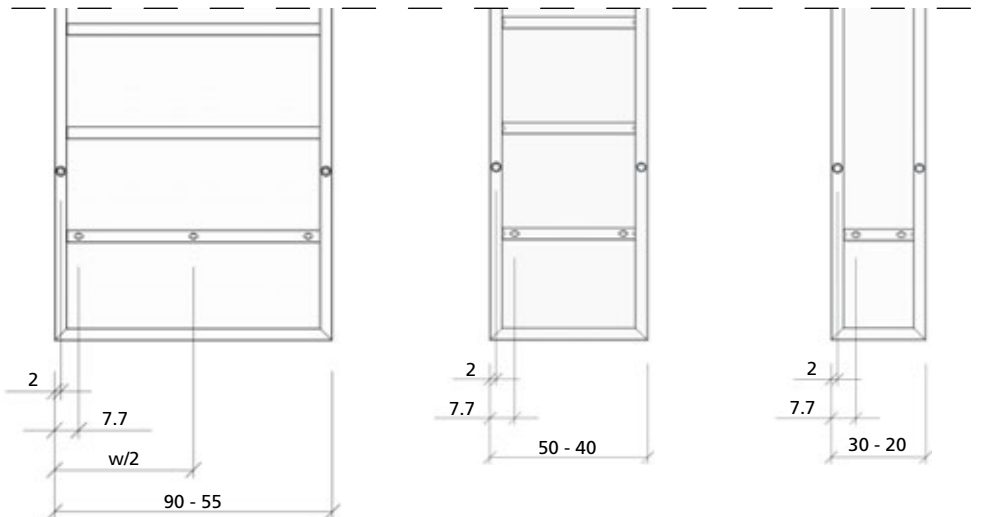
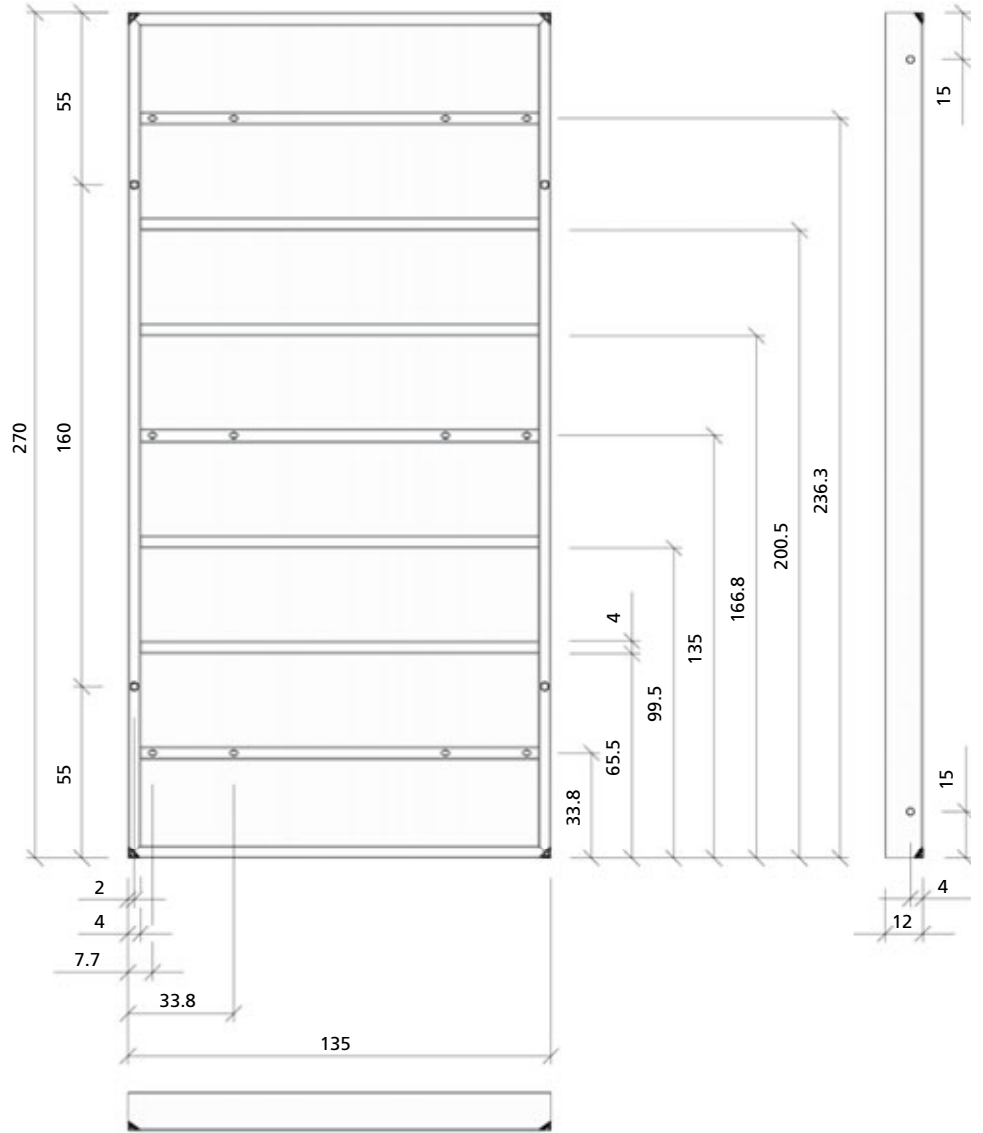

Panel height = 135 cm StarTec

3 cross stiffeners of which 2 are multi-function profiles (welded-in nuts with DW thread)

1 tie hole per panel height (and an additional tie hole in the front area for horizontal use when forming foundations)

Attention

Tie holes that are not used must always be closed with plastic plug D20.

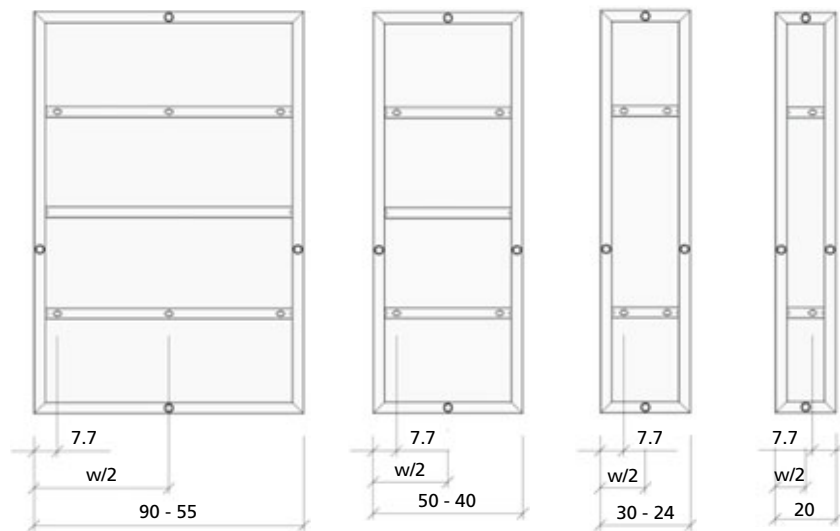
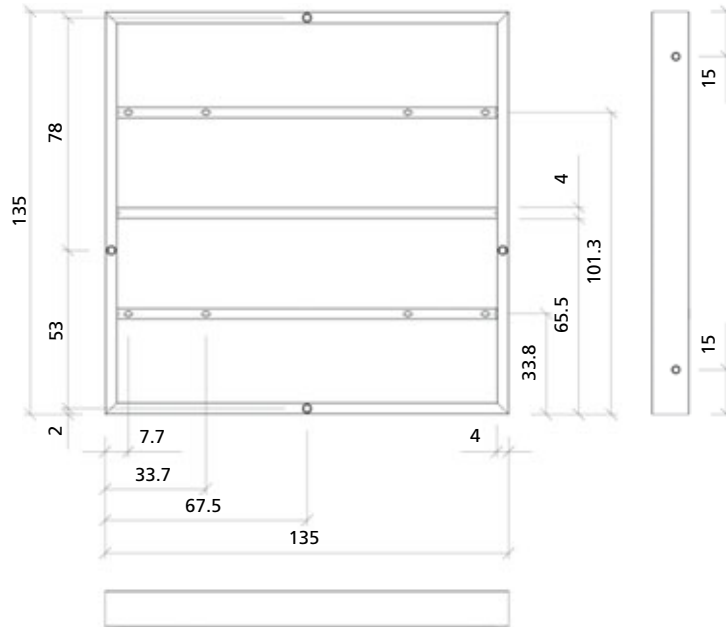

Panel height = 90 cm StarTec

2 cross stiffeners that are multi-function profiles (welded-in nuts with DW thread)

1 tie hole per panel height

Attention

Tie holes that are not used must always be closed with plastic plug D20.

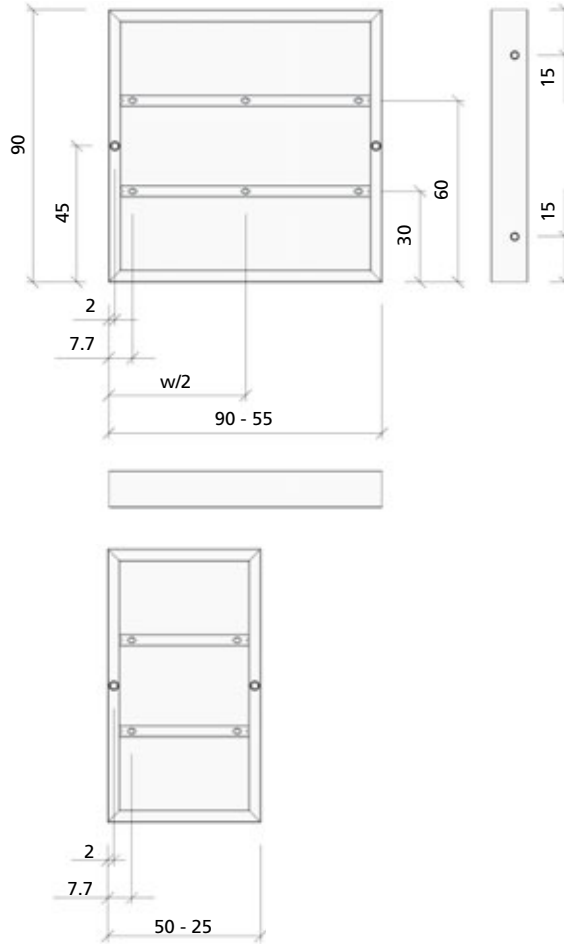

ST panel 135/240 AL20

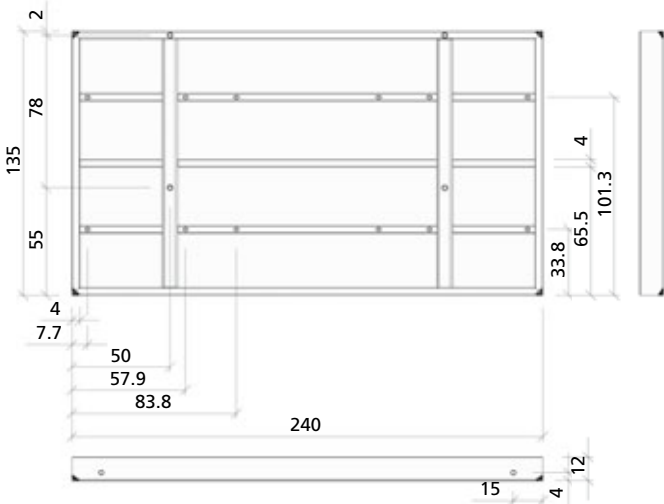

ST panel 75/240 AL20

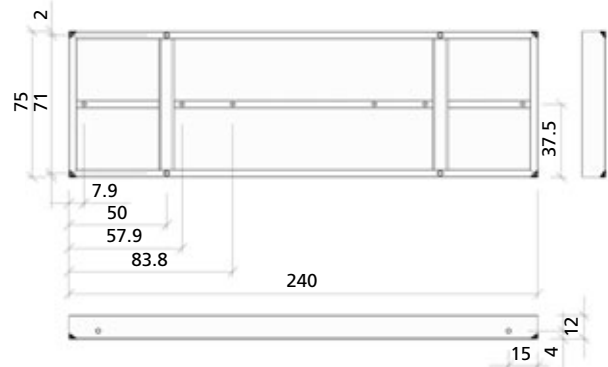

ST multi-Purpose panel 270/75

9 cross stiffeners of which 4 are multi-function profiles (welded-in nuts with DW thread)

3 tie holes per panel height

ST multi-purpose panel 135/75

4 cross stiffeners of which 2 are multi-function profiles (welded-in nuts with DW-thread). 1 cross stiffener is perforated.

1 tie hole per panel height (and a tie hole in the front for horizontal use when forming foundations)

Attention

Tie holes that are not used must always be closed with plastic plug D20.

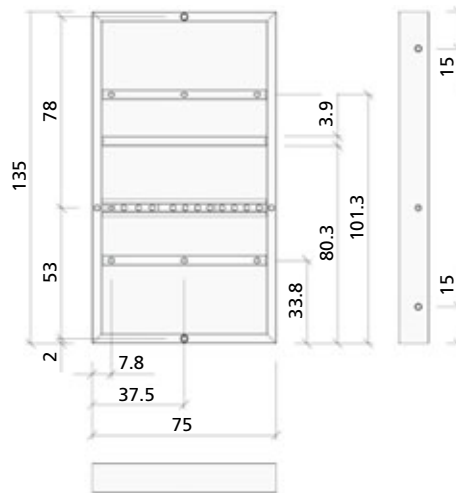
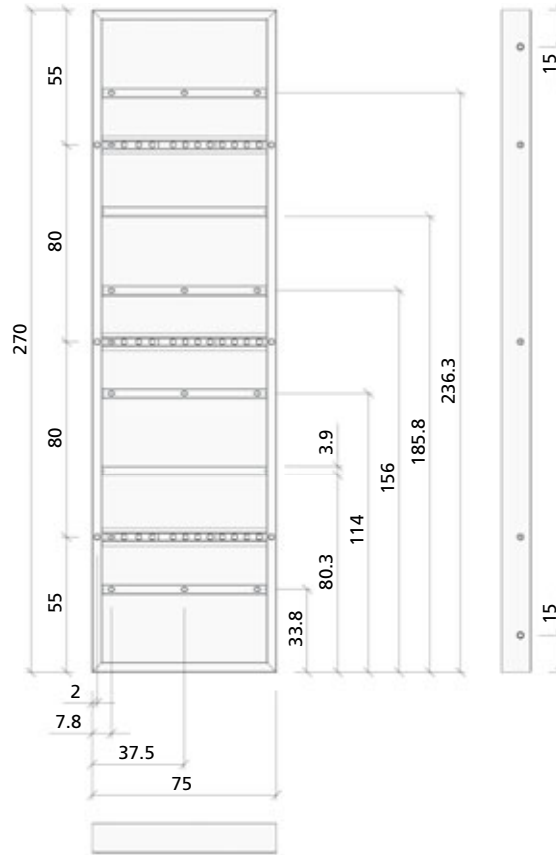

AS panels

Construction height 12 cm; frame profile width 4 cm; two tie holes per panel height 270 cm. Absolute compatibility with StarTec panels.

The frames of AS panels are made of closed 2-chamber aluminium profiles and are torsion-proof; easy to clean thanks to a special plastic coating. AS panels are standardly fitted with alkus AL 17 all-plastic forming face. As an alternative, they can be delivered with a multi-layer plywood face (15 mm).

All-around grooves and AS assembly locks guarantee a tight and perfectly aligned panel connection. Conical anchor sleeves are welded into the frames. Multi-function profiles permit an easy, fast and safe accessory attachment.



Ref. No.	Description / Application	m ²	kg
22-083-01	AS panel AL 17 270/90	2.43	65.0
22-084-01	AS panel AL 17 270/75	2.03	53.0
22-084-31	AS panel AL 17 270/55	1.49	41.0
22-084-34	AS panel AL 17 270/50	1.35	36.0
22-084-37	AS panel AL 17 270/49	1.32	36.0
22-084-46	AS panel AL 17 270/45	1.22	32.0
22-084-56	AS panel AL 17 270/40	1.08	30.0
22-084-71	AS panel AL 17 270/30	0.81	25.0
22-084-76	AS panel AL 17 270/25	0.68	23.0
22-084-81	AS panel AL 17 270/24	0.65	23.0
22-084-86	AS panel AL 17 270/20	0.54	22.0
22-085-01	AS panel AL 17 135/90	1.22	29.0
22-086-01	AS panel AL 17 135/75	1.01	24.0
22-086-31	AS panel AL 17 135/55	0.74	19.0
22-086-34	AS panel AL 17 135/50	0.68	18.0
22-086-37	AS panel AL 17 135/49	0.66	18.0
22-086-46	AS panel AL 17 135/45	0.61	17.0
22-086-56	AS panel AL 17 135/40	0.54	16.0
22-086-71	AS panel AL 17 135/30	0.41	14.0
22-086-76	AS panel AL 17 135/25	0.34	13.0
22-086-81	AS panel AL 17 135/24	0.32	12.0
22-086-86	AS panel AL 17 135/20	0.27	11.0

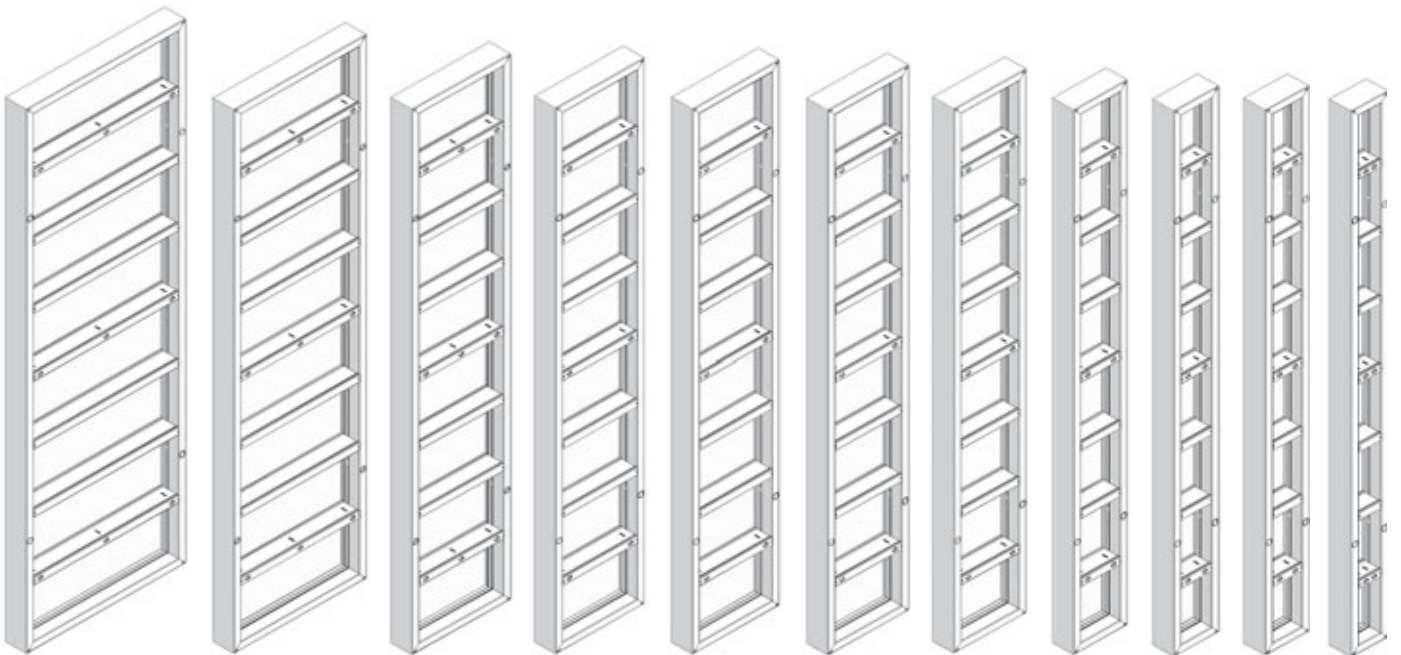

Panel height = 270 cm AluStar

7 cross stiffeners of which 3 are multi-function profiles (welded-in nuts with DW thread)

2 tie holes per panel height

Attention

Tie holes that are not used must always be closed with plastic plug D20.

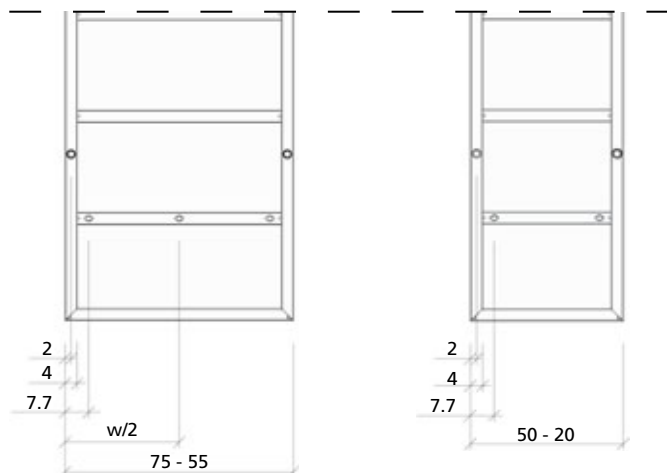
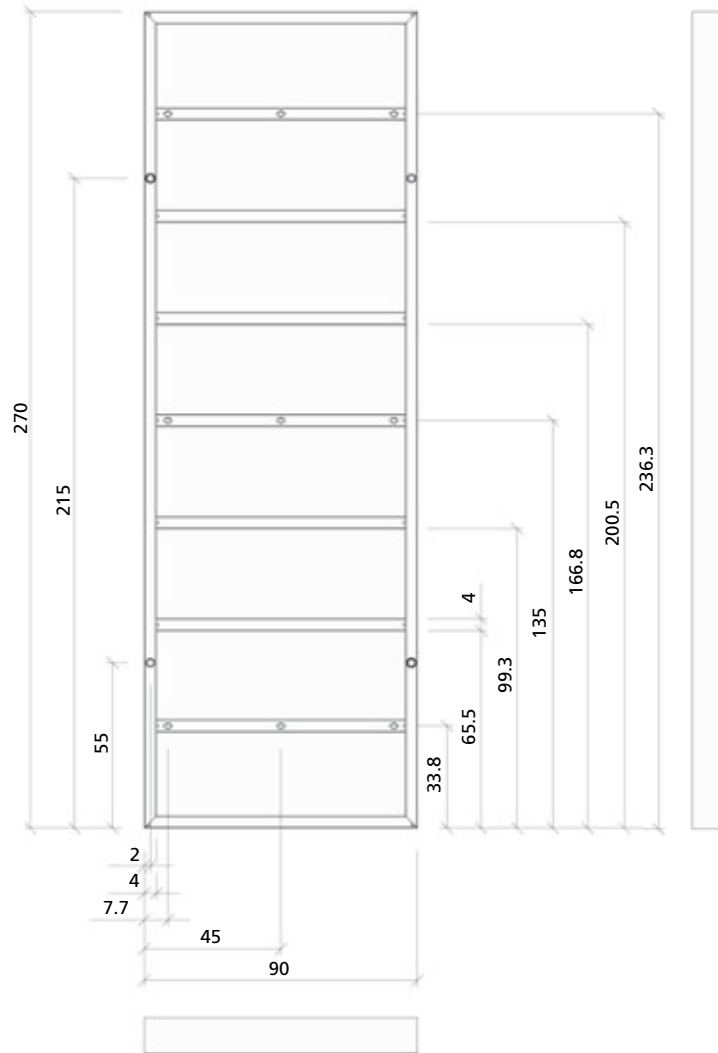

Panel height = 135 cm AluStar

3 cross stiffeners of which 2 are multi-function profiles (welded-in nuts with DW thread)

1 tie hole per panel height (and an additional tie hole at the front area for horizontal use when forming foundations)

Attention

Tie holes that are not used must always be closed with plastic plug D20.

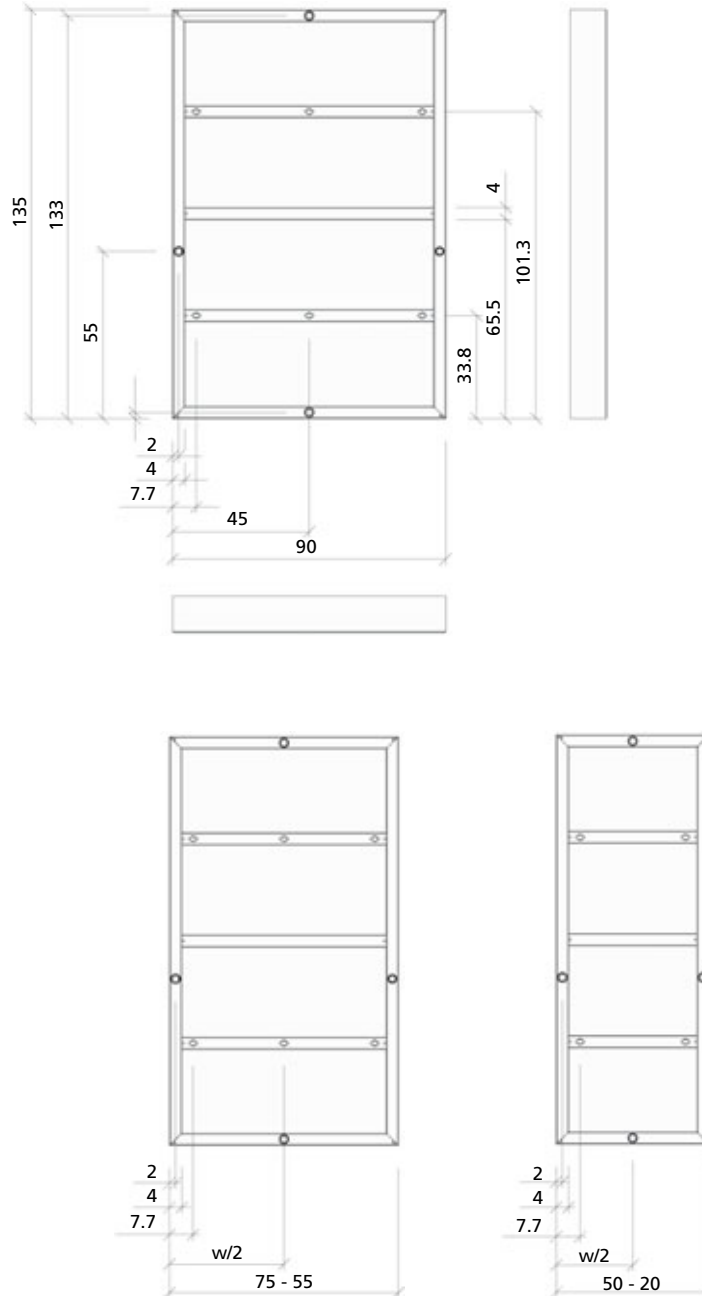

ST panel AL 17, 270/45 with filling nozzle

Is used when concrete cannot be poured from above, e.g. tunnel formwork. Connection with a manual gate valve. Operating pressure: 20 bar.

ST panel 270/45 with concreting window

Is used to control the concreting process when pouring and control is not possible from above

ST inside corner

For 90° corners; side length 25 cm. Steel frame with tie holes and alkus facing or exchangeable steel sheet. The frame and steel face are KTL/ACC-coated, the frame also has an annealed plastic coating.

AS inside corner

Aluminium; plastic-coated; for 90° corner configurations. Side length 25 cm, with tie holes.



Ref. No.	Description / Application	m ²	kg
21-213-55	ST panel AL 17. 270/45 with filling nozzle	1.21	69.0
29-914-50	Manual gate valve SK 100 - 4 1/2		19.0
29-914-45	Manual gate valve SK 125 - 5 1/2		15.6
29-207-60	Lever coupling SK-H DN 100 -4 1/2		3.8
29-207-65	Lever coupling SK-H DN 125 -4 1/2		5.1
29-207-50	Filling nozzle cleaner SK 100/800		7.2
29-207-55	Filling nozzle cleaner SK 125/800		9.6
62-031-55	Sealing washer A SK 100 - 4½		0.1
62-031-56	Sealing washer A SK 100 - 5½		0.2
21-213-60	ST panel 270/45 with concreting window	1.21	75.0
21-251-05	ST inside corner 270/25 AL	1.35	69.5
21-251-35	ST inside corner 135/25 AL	0.68	38.0
21-251-65	ST-Innenecke 90/25 AL	0.23	27.0
21-250-05	ST inside corner. 270/25 two parts	1.35	89.0
21-250-35	ST inside corner. 135/25 two parts	0.68	48.0
21-250-65	ST inside corner. 90/25 two parts	0.23	35.9
22-150-23	AS inside corner 270/25	1.35	32.0
22-150-33	AS inside corner 135/25	0.68	16.0

ST inside corner

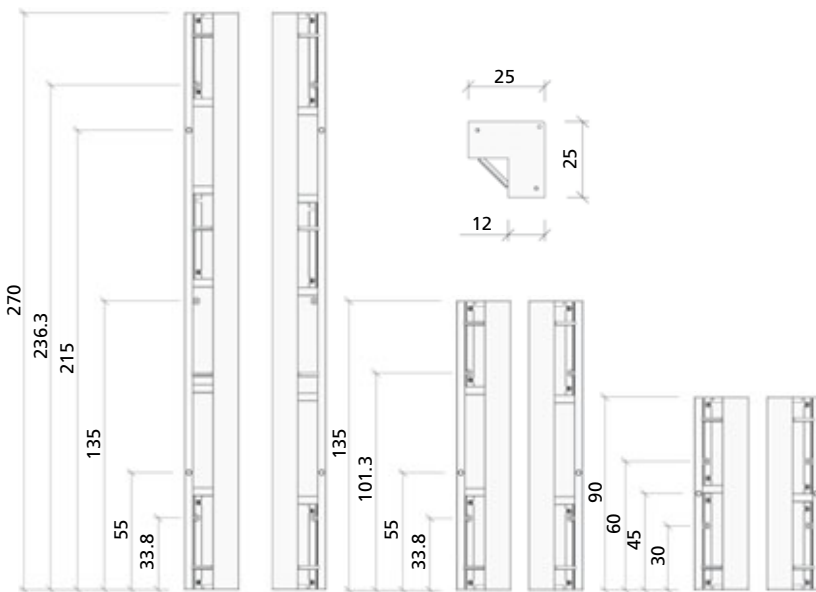

AS inside corner



AS/ST outside corner

Aluminium; plastic-coated. Together with ST panels and AS assembly locks it provides a fast and stable outside corner assembly for 90° angles



Ref. No.	Description / Application	m ²	kg
22-140-20	AS/ ST outside corner 270		13.0
22-140-30	AS/ ST outside corner 135		6.8
22-140-40	AS/ ST outside corner 90		4.8
22-140-25	Outside corner 270/5 Alu	0.27	16.1
22-140-35	Outside corner 135/5 Alu	0.14	8.4

AS/ST outside corner

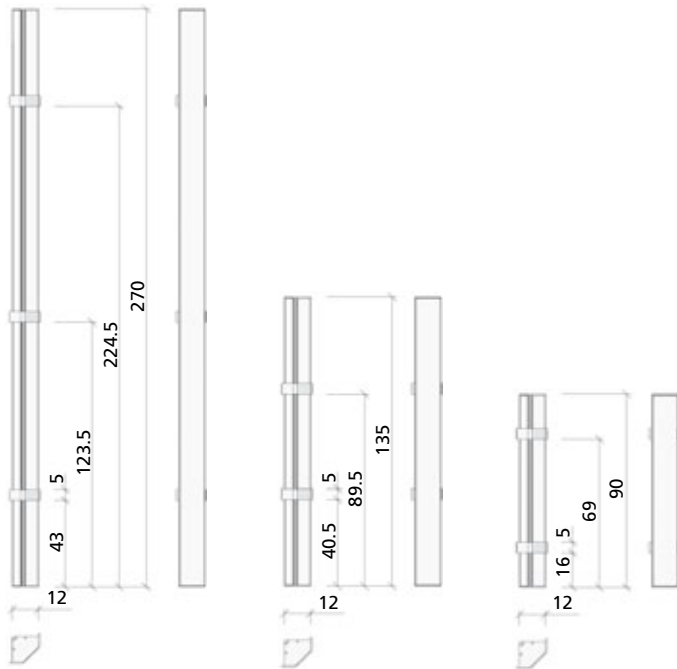

Outside corner Alu

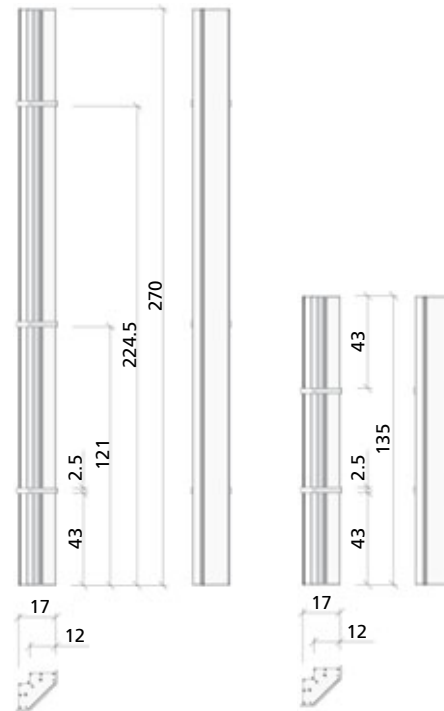

ST Inside Corner 135°

Steel construction with steel sheeting, KTL/ACC-coating (anti-corrosion treatment); for 135° corner configurations. Side length 15 cm, with tie holes.

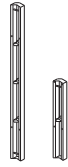

ST outside Corner 135°

Steel construction with steel sheeting, KTL/ACC-coating (anti-corrosion treatment). Outside corner with tie holes suited for 135° corner configurations. Side length 25 cm.



Ref. No.	Description / Application	m ²	kg
21-250-10	ST inside corner 135°, 270/15	0.81	51.0
21-250-40	ST inside corner 135°, 135/15	0.41	27.0

21-260-10	ST outside corner 135°, 270/25	1.37	78.0
21-260-40	ST outside corner 135°, 135/25	0.68	41.0

ST inside corner 135°

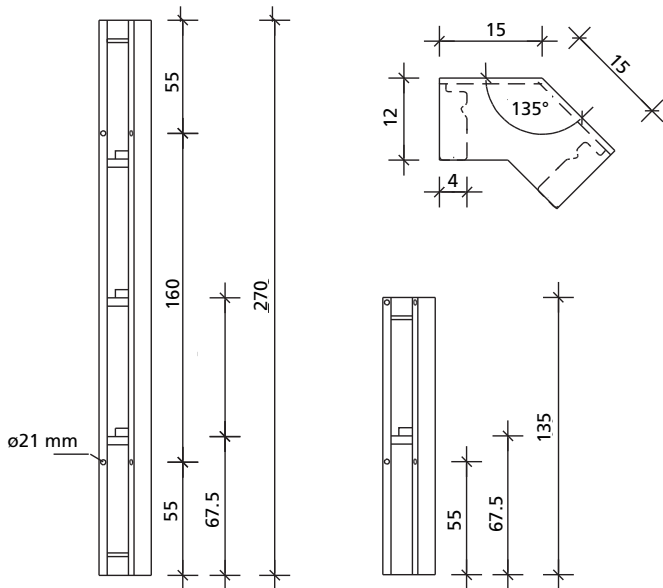

ST outside corner 135°

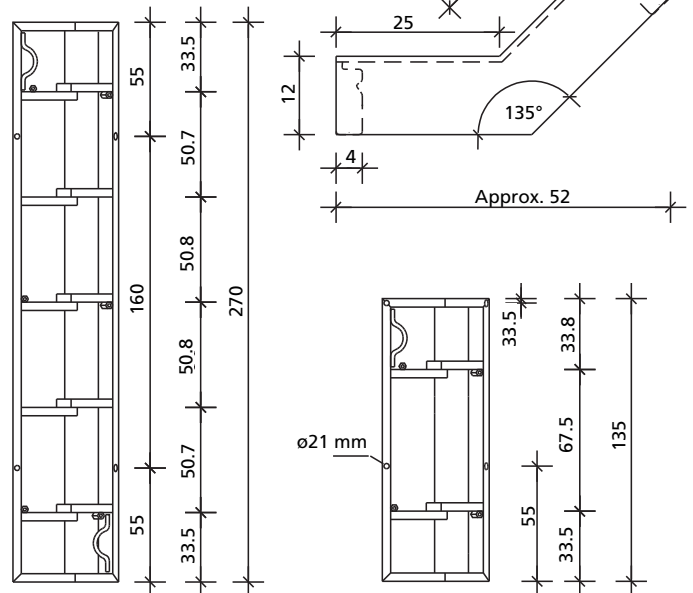

AS hinged inside corner

Steel construction with steel sheeting, KTL/ACC-coating (anti-corrosion treatment). Side length 30 cm. Adjustable angle 60°–180°.

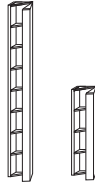

AS hinged outside corner

Steel construction with steel sheeting, KTL/ACC-coating (anti-corrosion treatment). Side length 7.5 cm. Adjustable angle 60°–180°.



ST stripping corner

Steel construction with steel sheeting, KTL/ACC-coated, side length 25 cm, with tie holes. When the bell-crank lever is pushed upwards with a crowbar, the corner is removed 17.5 mm away from the concrete and the formwork 35 mm away from the concrete on both sides.



Ref. No.	Description / Application	m ²	kg
21-270-00	AS hinged inside corner 270/30	1.62	73.0
21-270-10	AS hinged inside corner 135/30	0.81	37.0

21-280-00	AS hinged outside corner 270/7.5	0.40	45.0
21-280-10	AS hinged outside corner 135/7.5	0.20	22.0

21-262-10	ST stripping corner 270/25	1.35	134.0
21-262-30	ST stripping corner 135/25	0.68	73.0

AS hinged inside corner

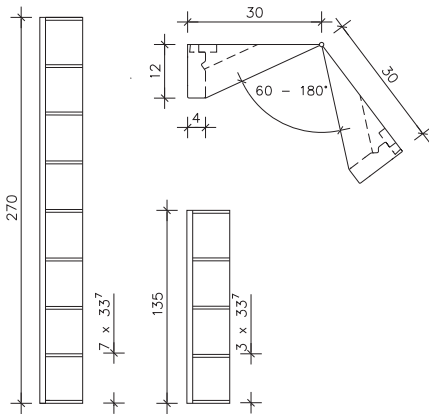

AS hinged outside corner

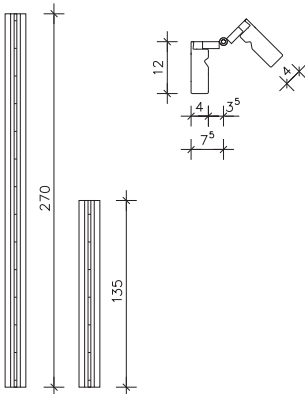

ST stripping corner

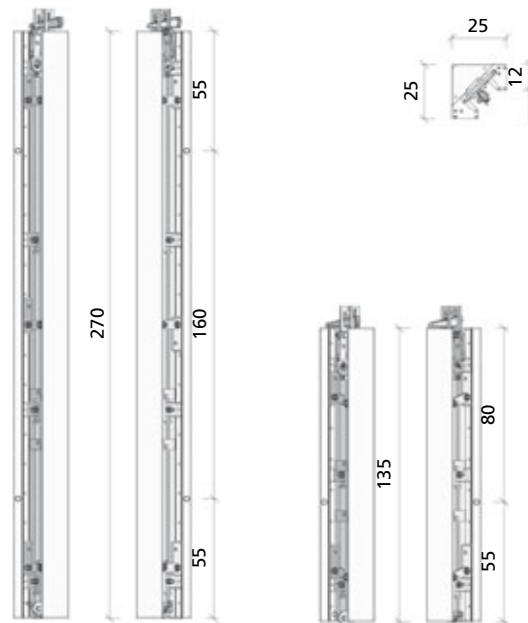

AS radius panel

Steel construction with steel sheeting, KTL/ACC-coating (anti-corrosion treatment). Enhances the application range of AluStar and StarTec formwork for a polygonal circle formwork.



AS tensioning bow

To take up the anchor load when forming polygonal constructions with radius panels



Ref. No.	Description / Application	m ²	kg
21-500-00	AS radius panel 270/15	0.41	38.9
21-500-10	AS radius panel 270/20	0.54	42.7
21-500-20	AS radius panel 270/25	0.68	50.0
21-500-40	AS radius panel 135/15	0.20	21.1
21-500-50	AS radius panel 135/20	0.27	23.0
21-500-60	AS radius panel 135/25	0.34	26.4
21-500-95	AS tensioning bow		5.4

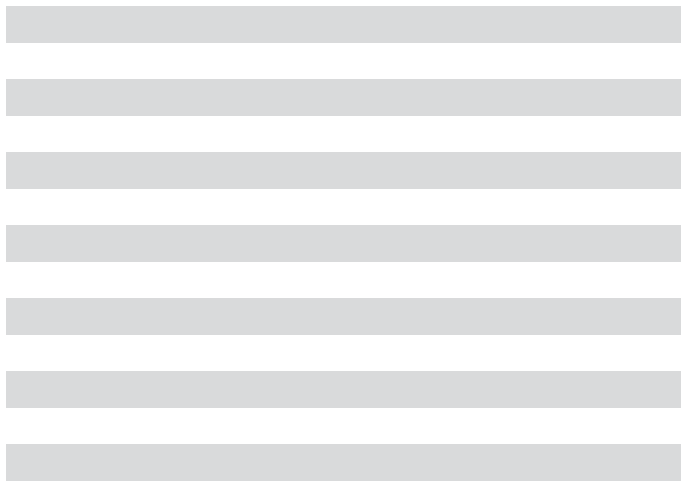

AS radius panel

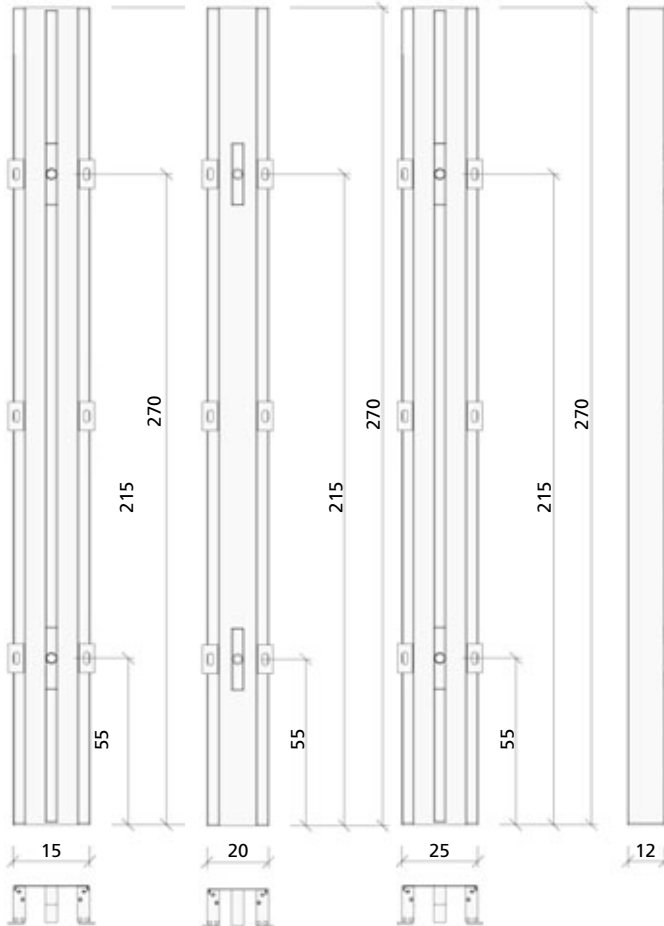

AS tensioning bow

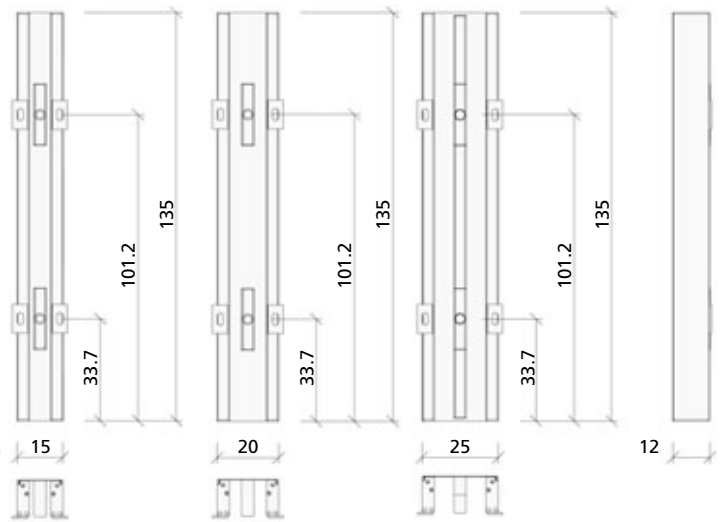
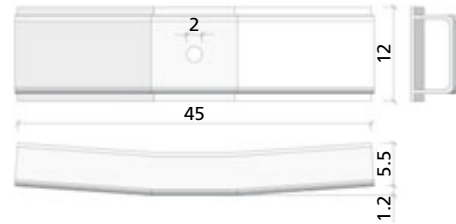

AS assembly lock

Galvanized; to tightly connect and align AluStar and StarTec panels. Clamping length 8 cm. 2 AS assembly locks are required per panel joint.



Uni-assembly lock

Galvanized; for stepless compensations; clamping length 22 or 28 cm



Combi-lock with coupling

Galvanized; to attach the push-pull props at the panel joint of the wall formwork AluStar, StarTec, Mammut and Mammut 350. Clamping length 8, 10 and 12 cm.



Ref. No.	Description / Application	m ²	kg
29-205-00	AS assembly lock		2.0
29-400-85	Uni-assembly lock 22		3.6
29-400-90	Uni-assembly lock 28		3.9
29-804-60	Combi-lock with coupling		3.7

AS assembly lock

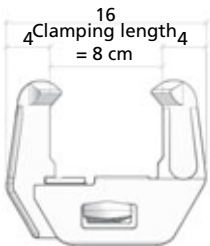
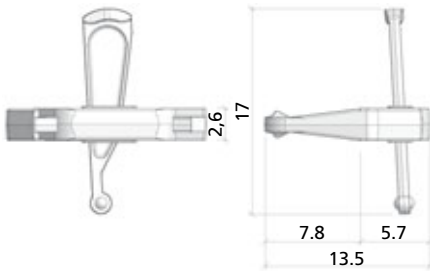

Uni-assembly lock



The numbers in parentheses refer to the Uni-Assembly lock 28

Adjustment range: 0–22 (0–28) cm



Combi-lock with coupling

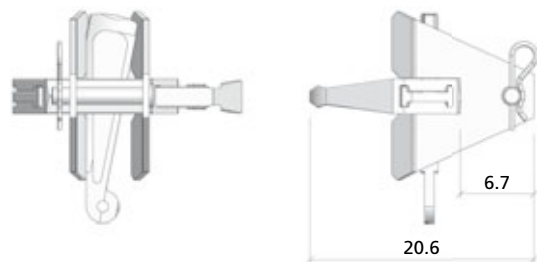

Clamping length 8, 10 and 12 cm



Flange screw

Galvanized, with Dywidag thread
 Ø 15 mm. To attach accessories, e.g.
 alignment rails, brace frames, push-
 pull props, etc. Length of thread 18 or
 28 cm.



ST aluminium filler

Made of aluminium and plastic-coated.
 With tie holes. For length compensa-
 tion of 5 cm, especially in corners. 2 or
 3 Uni-assembly locks are required for
 each filler.



ST compensation plate

Steel construction with steel sheeting,
 KTL/ACC-coating (anti-corrosion treat-
 ment). To compensate gaps of 8 to
 20 cm; is attached to the panel with 2
 assembly locks; alignment rails have to
 be used to bridge and align the panels
 with the compensation plate.



Flange screw 18

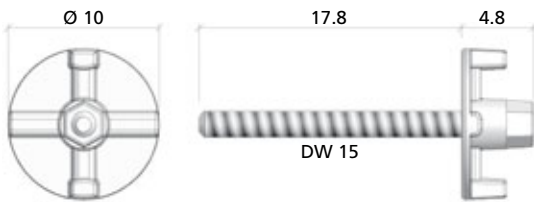

Ref. No.	Description / Application	m ²	kg
29-401-10	Flange screw 18		1.1
29-401-12	Flange screw 28		1.2

21-270-60	ST aluminium filler 270/5		7.9
21-270-65	ST aluminium filler 135/5		4.2

21-300-20	ST compensation plate 270/20		30.0
21-300-30	ST compensation plate 135/20		15.0

ST compensation plate

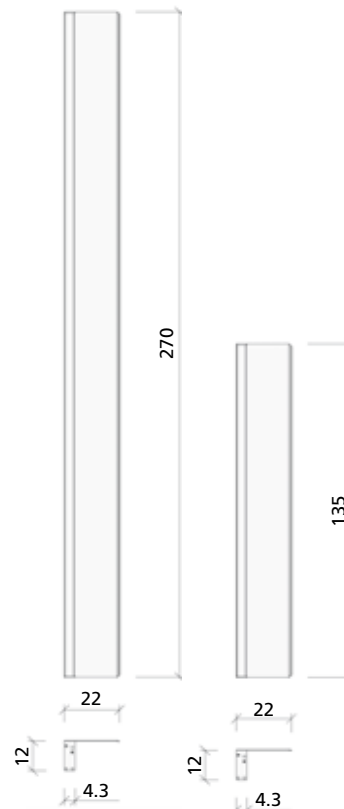

AS timber profile

Timber profile with groove. To support job-built fillers of 14 cm or more or to connect job-built formwork with 21 mm forming face; is attached to the AS/ST panels with 2 AS assembly locks. Delivery and weight by pairs.



Alignment rails

Galvanized; to brace panel joints for crane ganging, to bridge problem areas, to brace compensation areas and to build stop ends with stop end fixtures. Is attached to the formwork with flange screws.



Ref. No.	Description / Application	m ²	kg
29-200-03	AS timber profile 270/21		5.5
29-200-05	AS timber profile 135/21		2.7
29-201-73	AS alignment rail 50, galvanized		4.0
29-201-75	AS alignment rail 125, galvanized		10.5
29-201-80	AS alignment rail 200, galvanized		16.0
29-400-92	M alignment rail 180, galvanized		24.8
29-402-50	M alignment rail 250, galvanized		34.5
29-402-40	M alignment rail 450		84.0

AS timber profile



AS alignment rail

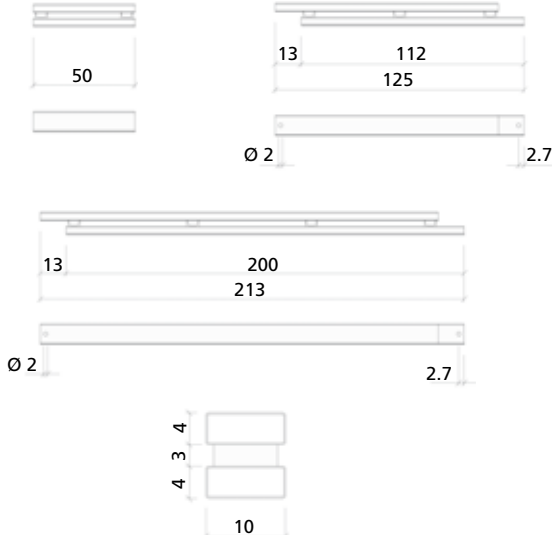

M alignment rail

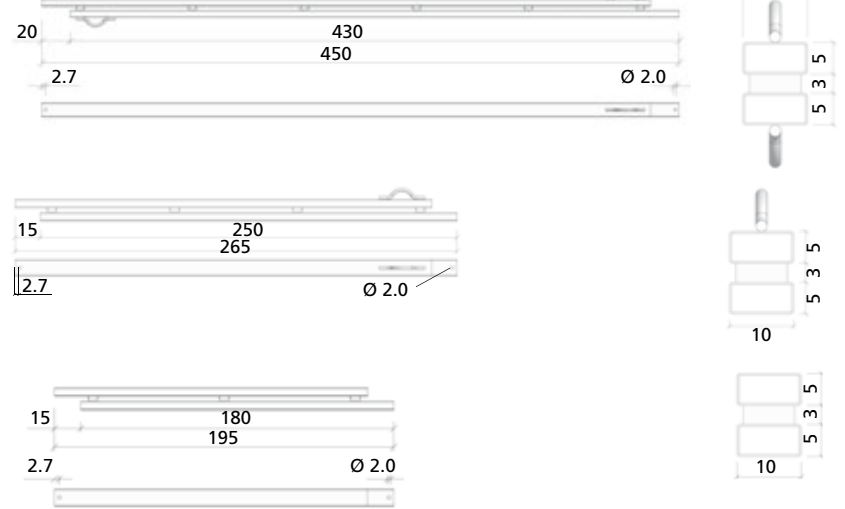

M outside corner bracket

Galvanized; together with AS/ST panels and flange screw 18 it provides a tight outside corner assembly. Primarily used for concreting heights over 405 cm.



Corner bracket 40/60

Galvanized; side lengths 40 and 60 cm. For inside and outside corners and column formwork.



Ref. No.	Description / Application	m ²	kg
23-137-63	M outside corner bracket, galvanized		12.0
29-402-25	Corner bracket 40/60		9.5

M outside corner bracket

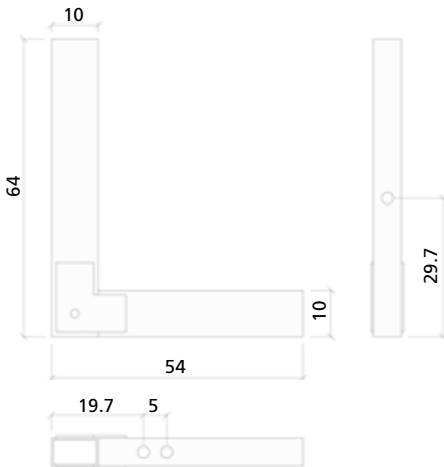

Corner bracket 40/60

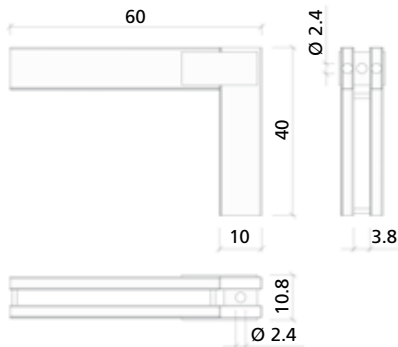

Stop end fixture 23/40 yellow

Yellow chromated. To attach alignment rails to panels when stop ends are formed; or it is used with multi-purpose panels (EcoAs, StarTec) to form outer corners or abutments. Suited for the frame profiles of EcoAs (23 mm) and AluStar/StarTec (40 mm). A flange nut 100 or an articulated flange nut 15/120 is also required.



Stop end bracket 40/60

Galvanized; to form stop ends; is suited for frame formwork panels with a profile width of 40 mm (AluStar, StarTec) and of 60 mm (Mammut, Mammut 350); maximum wall thickness 40 cm



Plug D20, red

To close unused tie holes of EcoAs, AluFix, AluStar and StarTec



Ref. No.	Description / Application	m ²	kg
29-402-85	Stop end fixture 23/40 yellow		3.0
29-105-50	Stop end bracket 40/60		15.4
29-902-63	Plug D20, red		

Stop end fixture 23/40

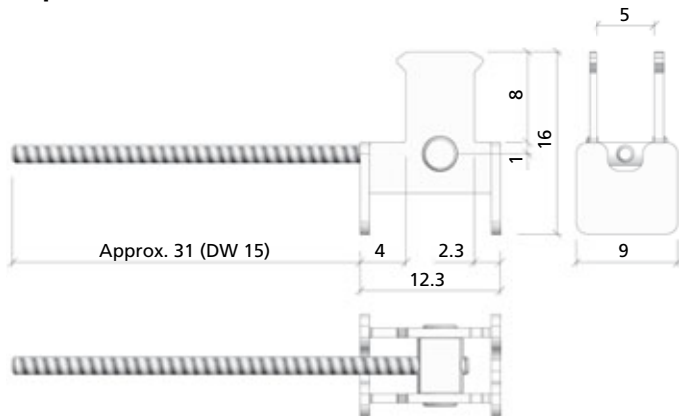

Stop end bracket 40/60

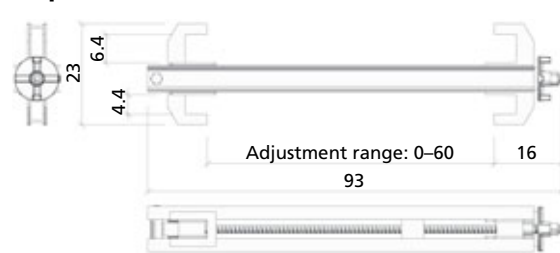

Articulated flange nut 15/120

Forged, galvanized; DIN 18216; with Dywidag thread 15 mm, plate Ø 120 mm. Maximum inclination 10°; spanner width 27 mm. Maximum load capacity 90 kN. Reduces the wear of panel coating.



Flange nut 100

Forged, galvanized; DIN 18216; with Dywidag thread Ø 15 mm, diameter of plate 100 mm; spanner width (SW) 27 mm. Admissible load capacity 90 kN



Tie rod DW 15/90

Uncoated, not weldable; DIN 18216; Dywidag thread Ø 15 mm; admissible load capacity: 90 kN. Is used to tie panels of double-sided formwork.



Ref. No.	Description / Application	m ²	kg
29-900-10	Articulated flange nut 15/120 (SW 27)		1.8
29-900-20	Flange nut 100 (SW 27), forged		0.7
29-900-80	Tie rod DW 15/90		1.3

Articulated flange nut 15/120

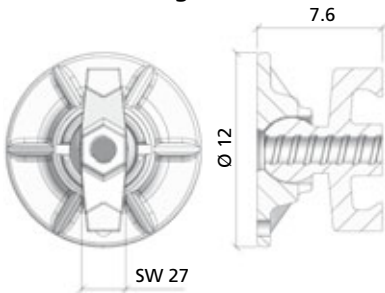

Tie rod DW 15/90



Flange nut 100

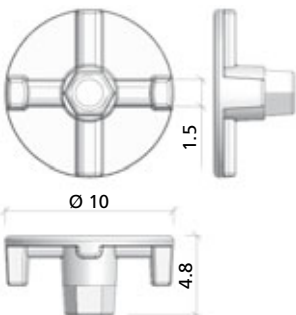

Uni-tie claw

Galvanized; permits tying directly above or beside the panels. Is suited for panels with a frame profile width of 40 mm (AluStar/StarTec) or 60 mm (Mammut/Mammut 350).



Spanner SW 27

Inset yellow chromated; spanner width 27 mm. To tighten and loosen flange nuts 100, articulated flange nuts 15/20 and flange screws.



AS crane hook

To move panels. Self-locking; load capacity: 15 kN (1.5 tons). Always 2 crane hooks required per gang. For use and safety check see the operating instructions.



Ref. No.	Description / Application	m ²	kg
29-901-41	Uni-tie claw		1.5
29-800-10	Spanner SW 27		1.8
29-203-89	AS crane hook		6.0

Uni-tie claw

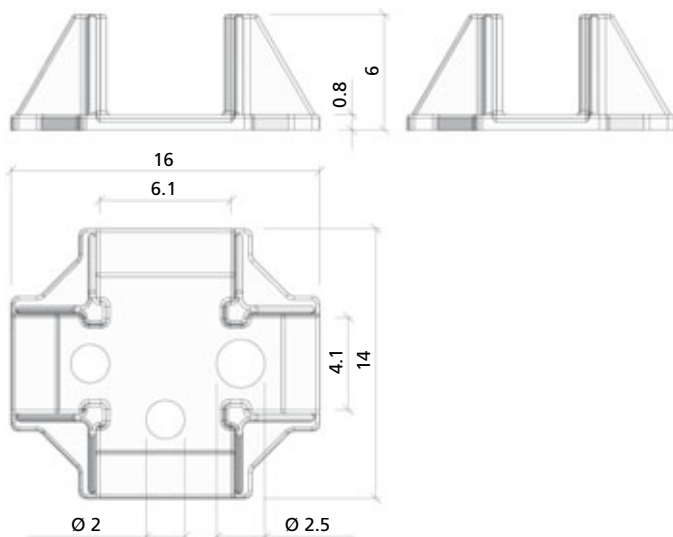

AS crane hook

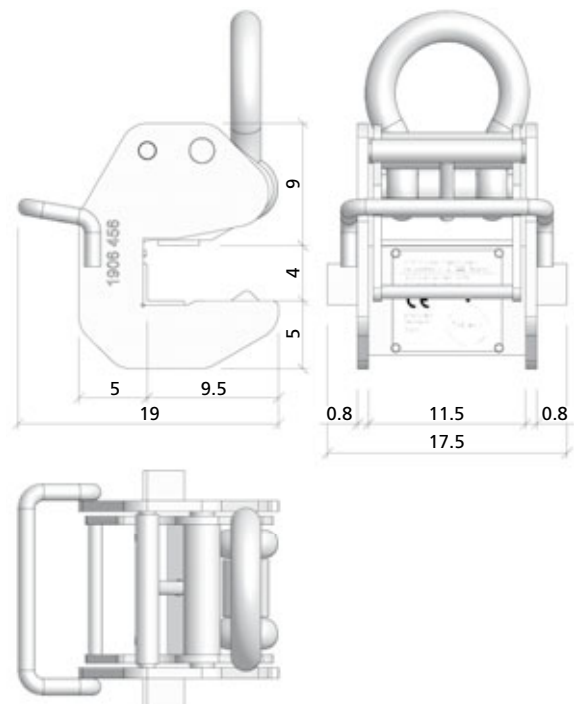

Crane slings 40

Four polyester ropes; length 5 m; with 60 cm lifting chain and 4 lifting hooks; maximum load capacity 20 kN (2 tons); to load and unload trucks and to move panel stacks near the ground



Lifting hook 40

Galvanized; with these lifting hooks, any 4-roped crane slings available on site can be used to move panel stacks. Always use 4 hooks at a time. For their use and safety check, see the operating instructions. Maximum load capacity 10 kN (1 ton) per lifting hook; maximum weight of panel stack 2 tons.



Crane slings Stapos 40

Not shown here. For panels with a frame width of 40 mm. Four crane slings are required to move and transport panel stacks. Maximum stacking height 126 cm = 10 panels. The maximum load capacity per crane sling is 10 kN; maximum stack weight 2 tons.

Ref. No.	Description / Application	m ²	kg
29-401-44	Crane slings 40		21.0
29-401-42	Lifting hook 40		1.5
29-403-20	Crane slings Stapos 40		3.1

Lifting hook

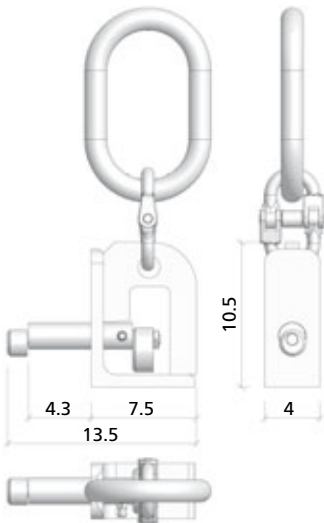

Transport angle 12

To stack and transport 5 to 12 frame formwork panels with a construction height of 12 cm and 12 cm hole distance. Maximum load capacity = 10 kN per angle; for safety reasons consider 20 kN as maximum capacity for the whole stack. It is recommended to use 2 foldable angles and 2 angles of the rigid-type for each stack.



Ref. No.	Description / Application	m ²	kg
29-305-20	Transport angle 12		16.5
29-305-25	Transport angle 12 rigid type		12.7



AS/ST

Transport angle 12

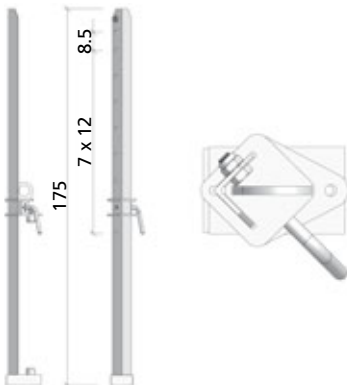
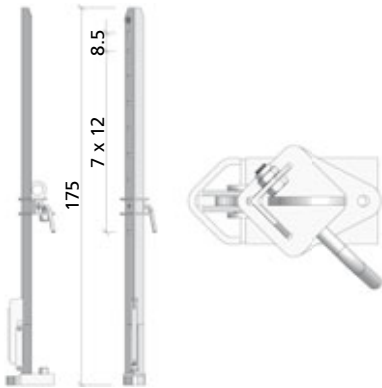

Scaffolding bracket

Galvanized, yellow, pluggable. Is used as a working and safety scaffold; is attached to the multi-function profile and secured to the multi-function profile below with a flange screw 18. The planking can be mounted to the brackets. Working width is approx. 90 cm (125 cm). Guard railing post 100 or 140 is also required. Bracket spacing depends on the type of planking and must be in line with DIN 4420. For details see the Assembly and Operating Instructions.



Side railing

Galvanized, pluggable; for scaffolding brackets



M profile for extension for guard-railing KLK

Painted; is used to attach the extension for guard-railing KLK and attached to the AluStar and StarTec panels with 2 Uni assembly locks



Ref. No.	Description / Application	m ²	kg
29-106-00	Scaffolding bracket 90 (yellow), galvanized		10.0
29-106-50	Scaffolding bracket 125 (yellow), galvanized		11.5
29-108-20	Side railing 90/100, galvanized		12.3
29-108-20	Side railing 1250/100, galvanized		12.3
29-411-72	M profile for extension for guard-railing KLK		5.0

Scaffolding bracket

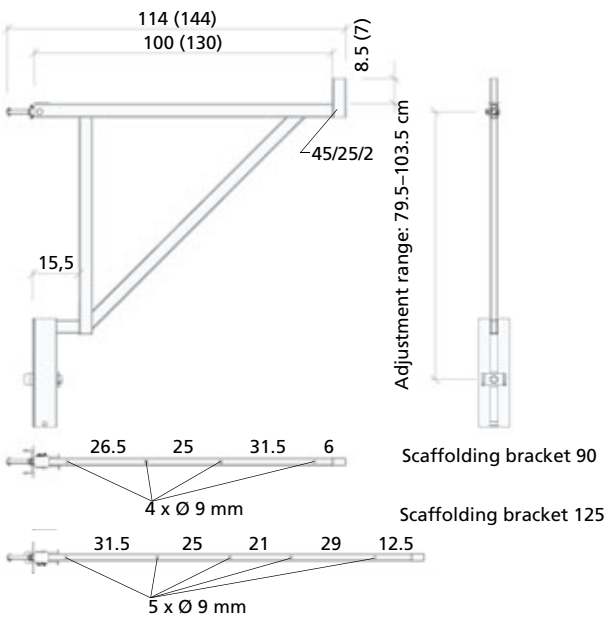

The numbers in parentheses refer to scaffolding bracket 125

Side railing

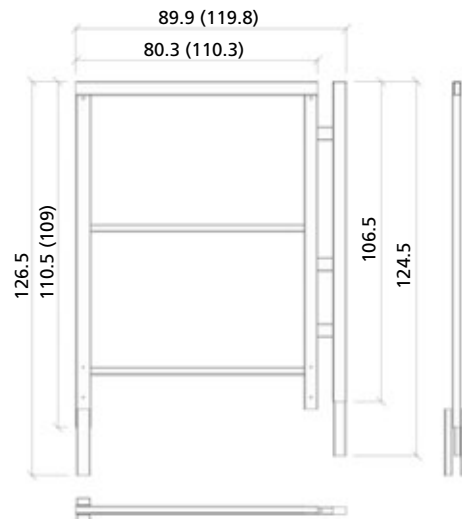

The numbers in parentheses refer to side railing 125/100.

Guard-railing post

Galvanized; is plugged into the scaffolding bracket

Guard-railing post UK

Galvanized; with a fitting element that is plugged into the scaffolding bracket and with a 48 mm Ø circular tube to attach the scaffolding tube couplings



Scaffolding tube

Not shown here. Galvanized; is used together with the guard-railing post UK.

Swivel-joint coupler 48/48

Galvanized; connects two scaffolding tubes with a 48.3 mm Ø at any angle



Ref. No.	Description / Application	m ²	kg
29-106-75	Guard-railing post 100, galvanized		3.7
29-106-85	Guard-railing post 140, galvanized		4.7
29-106-80	Guard-railing post 48/120 UK		5.5
29-412-23	Scaffolding tube 48/200		9.4
29-412-26	Scaffolding tube 48/300		14.1
29-412-27	Scaffolding tube 48/400		18.8
29-412-52	Swivel-joint coupler 48/48		1.2

AS/ST

Guard-railing post

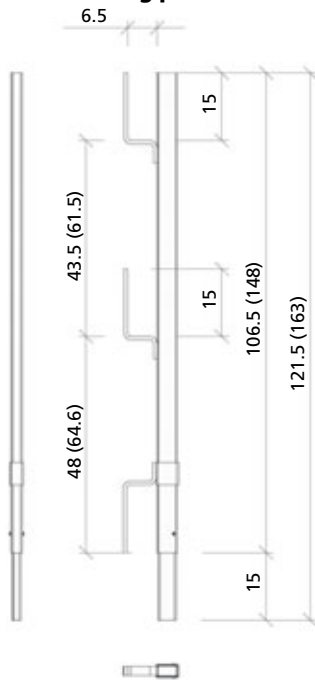

The numbers in parentheses refer to guard-railing post 140

Guard-railing post 48/120 UK

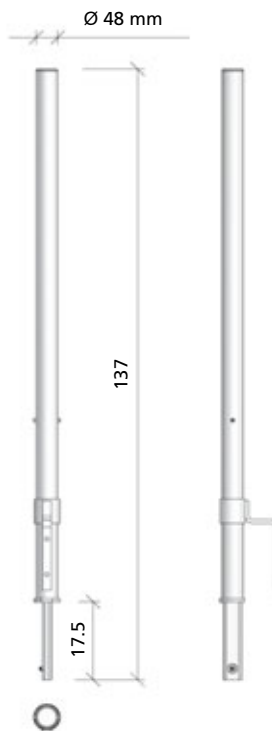

Brace frame 250

Galvanized; to align and brace the formwork. Available with our without formwork-prop connector; it consists of a push-pull prop R 250 (190-320 cm), a brace SRL 120 (90-150 cm) and a double-jointed foot plate; the formwork prop connectors are attached to the formwork with flang screws 18.



Formwork-prop connector

Galvanized; to connect braces, brace frames and push-pull props (maximum Ø 48 mm) to the multi-function profile by means of a flange screw 18. Delivery includes head bolt 16/90 and cotter pin 4.



Ref. No.	Description / Application	m ²	kg
29-109-25	Brace frame 250 without connector		27.5
29-109-20	Brace frame 250 with formwork-prop connector		31.5

29-804-85	Formwork-prop connector		1.7
-----------	-------------------------	--	-----

Brace frame 250

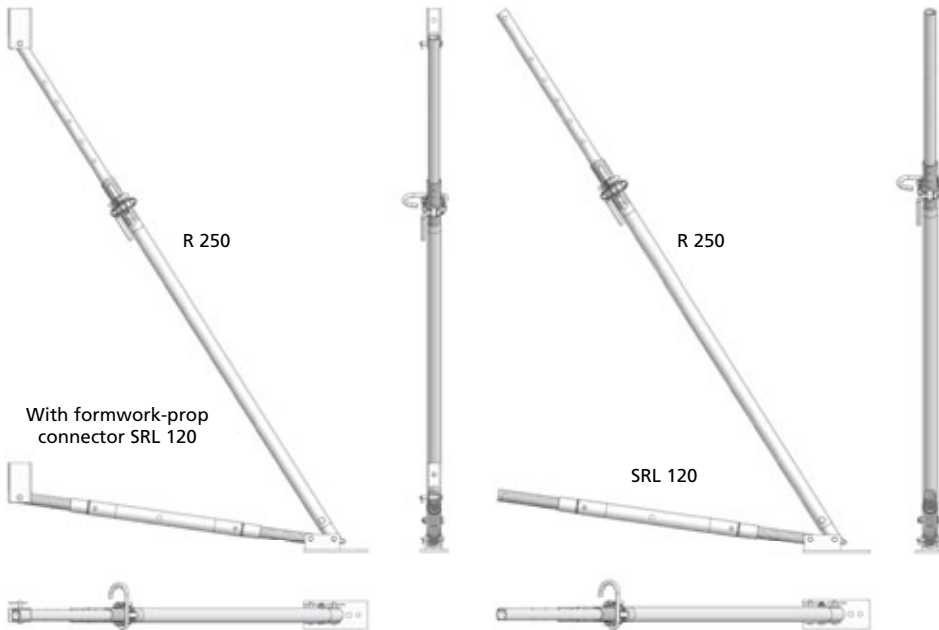

Formwork prop connector

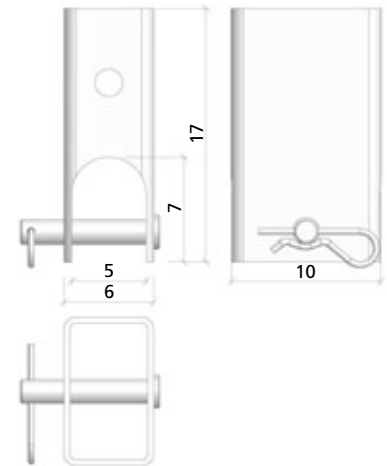

Foundation tape

Galvanized; hole spacing 50 mm; hole Ø 16 mm; length 50 m; admissible tractive force 10 kN; to be cut at hole center. Together with the appropriate tensioners it serves as bottom anchoring when panels are assembled in horizontal position.



Tensioner AS/ST for foundation tape

Galvanized; to connect the foundation tape to AluStar or StarTec panels; it serves as bottom anchoring when panels are assembled in horizontal position. Two tensioners are required per anchoring position.



Trolley for foundation tape

Not shown here. Galvanized; to transport and cut foundation tape to length; suitable for one roll; pneumatic wheels.

Push-pull strut

Galvanized, resistant against pressure and tractive force. Is attached over the panel joint and replaces the top tie in case of horizontal panels (up to a wall or foundation width of 60 cm).



Ref. No.	Description / Application	m ²	kg
29-307-50	Foundation tape, 50 m		20.0
29-307-70	Tensioner AS/ST for foundation tape		1.7
29-307-55	Trolley for foundation tape		21.8
29-105-70	Push-pull strut		6.6

Foundation tape

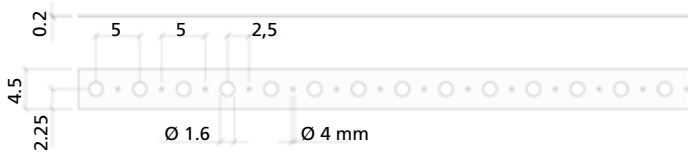

Push-pull strut

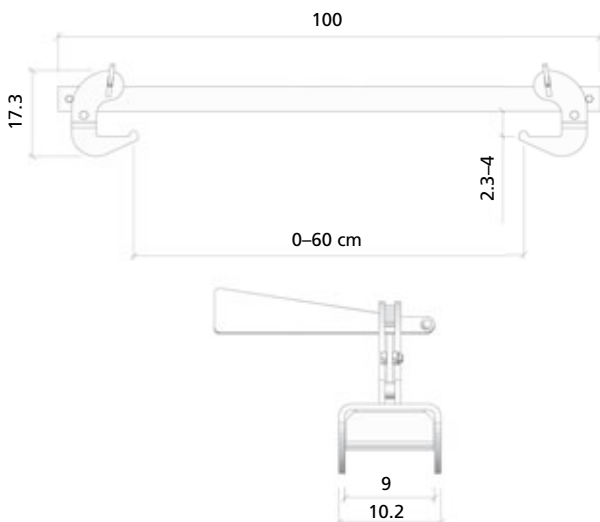

Tensioner for foundation tape AS/ST

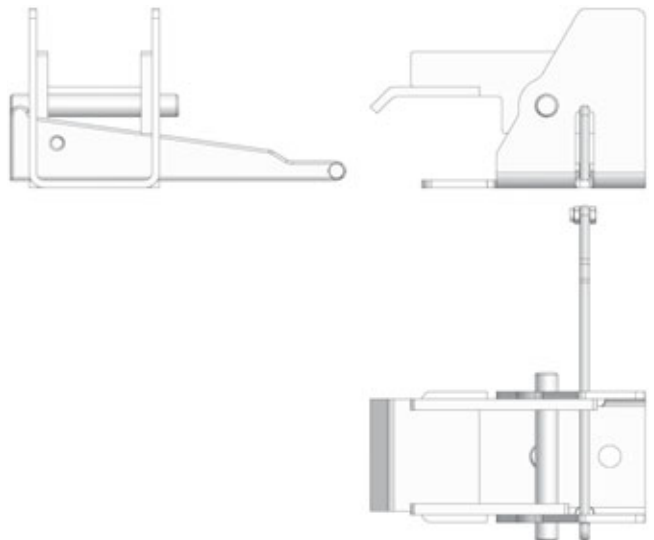

Folding access platform BKB 125

Self-locking; ready-made platform with a foldable guard-railing and an overall width of 125 cm; it is suspended onto the frame profile of the panels. The 48 mm thick planking is protected at the front ends. Stacking height 17 cm; load capacity 2 kN/m². This platform is used with the formwork systems AluStar, StarTec, Mammut and Mammut 350.

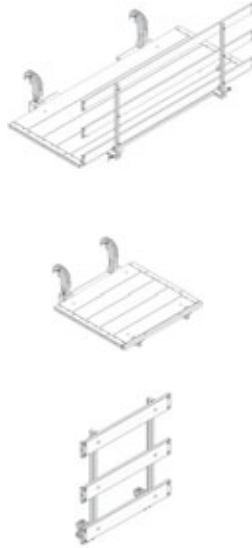

Ref. No.	Description / Application	m ²	kg
79-417-10	Folding access platform BKB 125/235	185.0	
79-417-20	Folding access platform BKB 125/300	205.0	
79-417-00	Folding access platform BKB 125/140	120.0	
79-417-30	Side railing BKB 125	17.0	

Folding access platform BKB 125/...

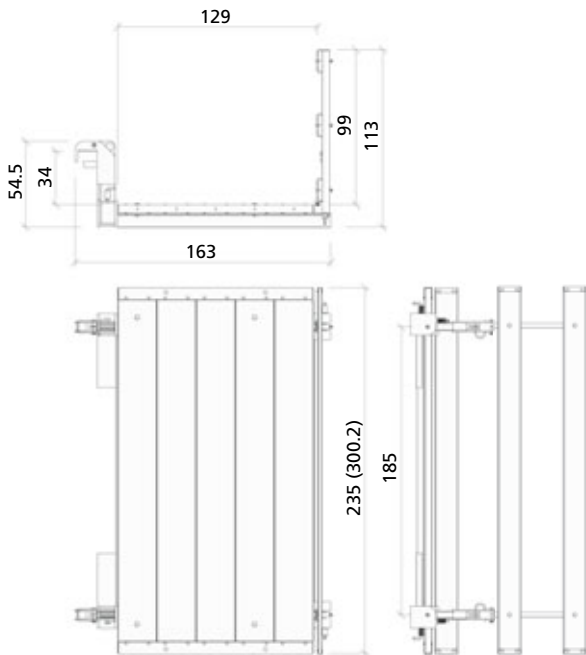

The numbers in parentheses refer to BKB 125/300

Folding access platform BKB 125/140

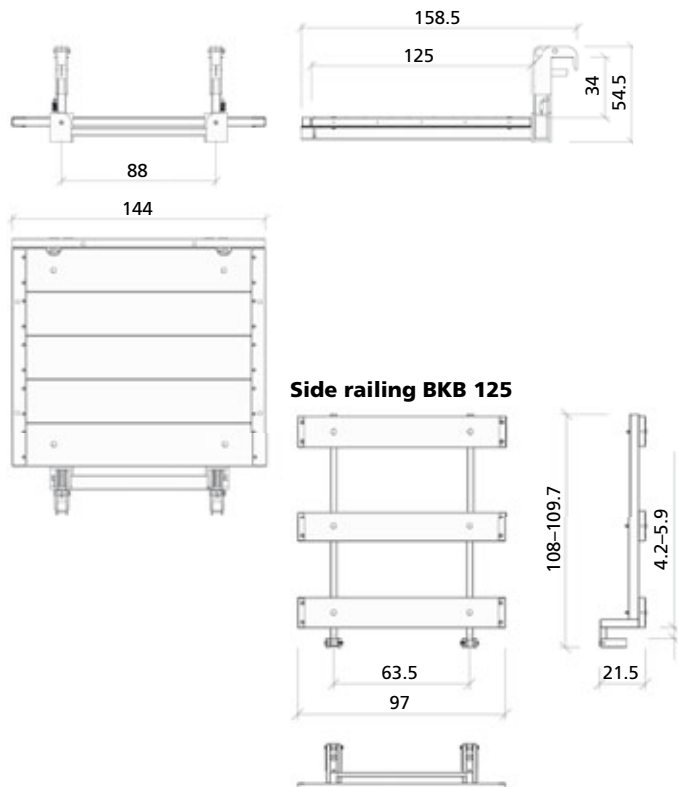

Notes

AS/ST



MEVA Schalungs-Systeme GmbH
Industriestraße 5
D-72221 Haiterbach
Tel. 07456 692-01
Fax 07456 692-66
e-mail info@meva-international.com
www.meva-international.com

A-Pfaffstätten, Tel. 02252 209000
BG-Sofia, Tel. 02 9898277
CDN-Toronto, Tel. 905 8576037
CH-Seon, Tel. 062 7697100
CZ-Praha, Tel. 0283 085333
F-Champs-sur-Marne 01 64621060
F-Sarreguemines, Tel. 0387 959938
H-Budapest, Tel. 01 2722222

NL-Gouda, Tel. 0182 570770
RO-Bukarest, Tel. 021 3169882
RUS-Moskau, Tel. 495 7813737
RUS-St.Petersburg, Tel. 812 3320188
UA-Kiew, Tel. 8044 4251312
UAE-Dubai, Tel. 04 3411180
UK-Tamworth, Tel. 01827 60217
USA-Springfield, Tel. 937 3280022